



The PhotoCake® ¼ Sheet Printer



On Top of the World's Best Selling Cakes

Operation

Load the media into the top tray. Insert one sheet of media, printable side up, into the top opening, resting on the support. (See yellow arrow diagram below)

Press the tray selection button shown to highlight the top tray selection – the top slash will light up green. (See red arrow diagram below)

Care and Maintenance

Keep the printer bed and rollers located inside the printer cover clean to prevent sheet feed problems. Wipe with a lightly dampened paper towel, monthly or as needed. Clean the surface of the printer with a soft, clean cloth lightly moistened with a mild detergent dissolved in water. It is recommended that you run a color test daily. Use the cleaning cartridge twice a month to ensure top performance.

Note: Never spray liquids directly onto or into your printer.

CAUTION



BE SURE TO PEEL THE EDIBLE MEDIA OFF THE BACKING MATERIAL BEFORE PLACING THE EDIBLE MEDIA INTO THE PRINTER'S TOP MEDIA TRAY.

Printing on edible media that is still attached to the backing material may cause the following problems: 1) The edible material may tear when an attempt is made to peel it away from the backing material and 2) Printing errors such as misalignment of the image can occur.

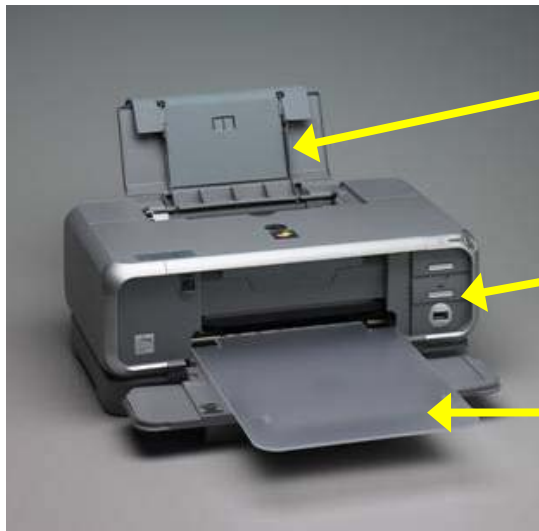

Top Tray –
Edible media
loads here

Tray Selection
Button

Front receiving
tray – Finished
toppings and
forms come out
here

The PhotoCake® ¼ Sheet Printer



Top Slash - Tray
Selection Button

Top Tray Selected

PhotoCake® III Connections between Console, Printer and Scanner

Connections are **color coded** for easy hook up.

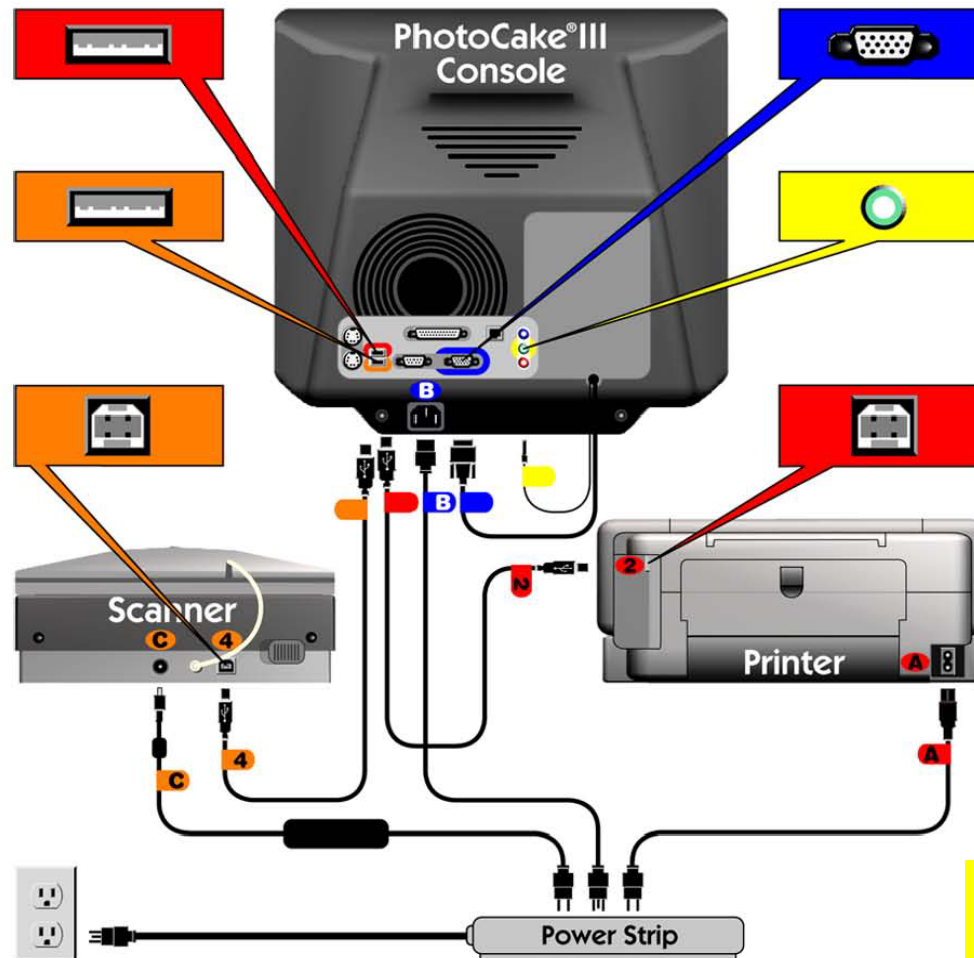

Questions?

Call our PhotoCake®
Tech Team @
1-800-644-1228